

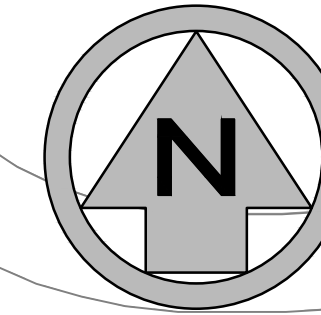

# NORTHGATE ARENA LEISURE CENTRE

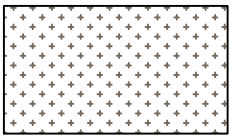

- Key:**
-  Existing traffic island to be removed
  -  Existing traffic island area to remain
  -  New or widened traffic island area
  -  New grassed area
  -  New 'tactile' paving

**Notes:**

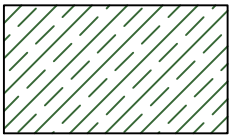
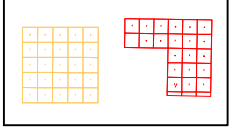
All new carriageway crossing points for both cyclists and pedestrians shall be traffic signal controlled

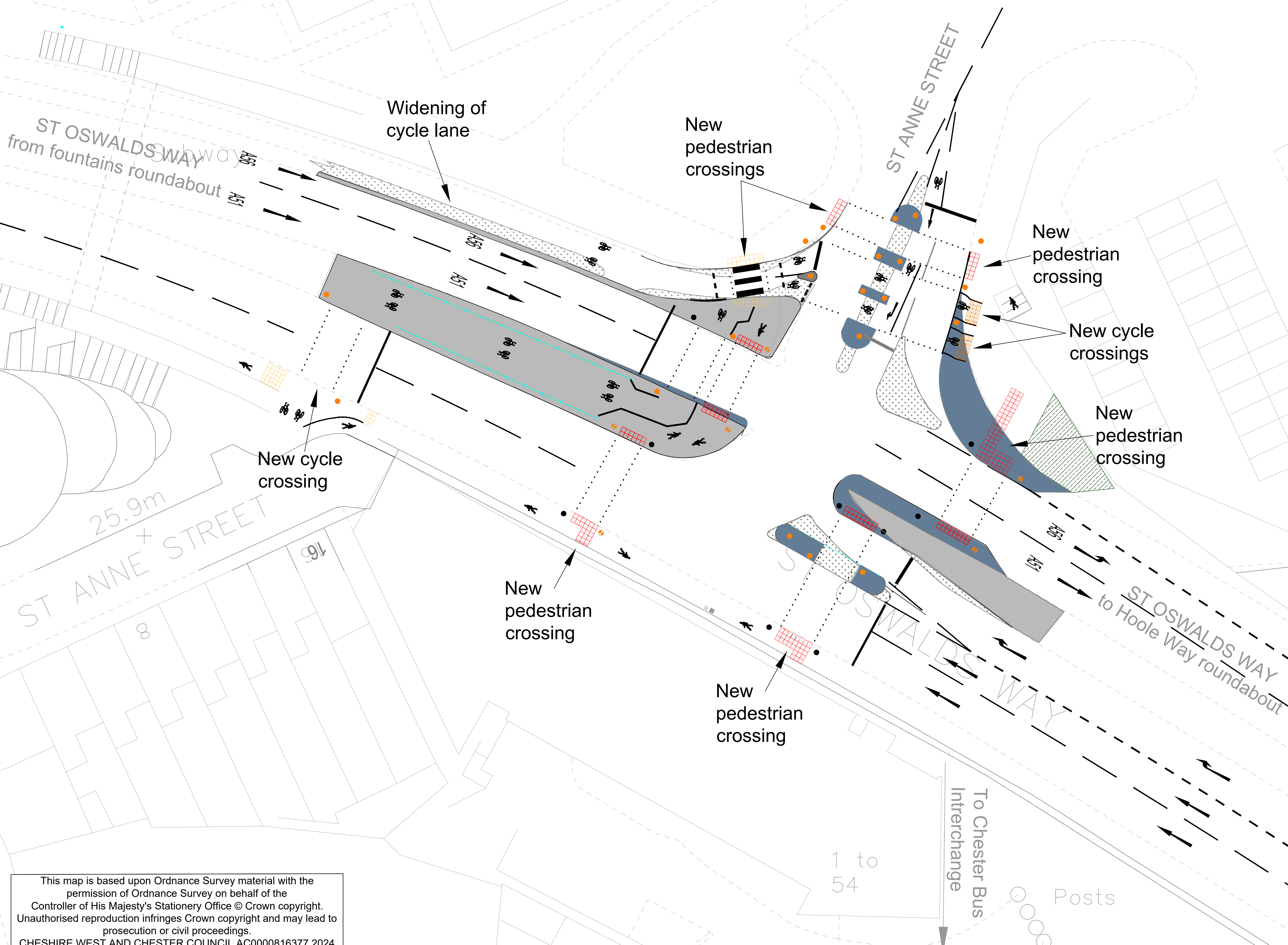

| Ph/Rev. | Revision Details | Rev.by | Chk.by | Date |
|---------|------------------|--------|--------|------|
|         |                  |        |        |      |



Project:

St. Anne St, Chester  
Proposed Junction Improvement Works

General Arrangement

|   |               |             |                        |
|---|---------------|-------------|------------------------|
| Cheshire West & Chester Council Highways Service, Nicholas House, Chester CH1 2NU |               |             |                        |
| Contact Name:   | Sian Williams | Telephone:  | 01244 97               |
| Drawn by:   | Sian Williams | Fax No:     | 01244 603771           |
| Checked by:   |               | Date:       | October 2023           |
| Scales at A1:   | 1:200         | Drawing No: | GS/St.Anne St / 50 /02 |
|   |               | Phase/Rev:  | D/B                    |

This map is based upon Ordnance Survey material with the permission of Ordnance Survey on behalf of the Controller of His Majesty's Stationery Office © Crown copyright. Unauthorised reproduction infringes Crown copyright and may lead to prosecution or civil proceedings.  
CHESHIRE WEST AND CHESTER COUNCIL AC0000816377 2024